

SPINNING REEL — PS700BL

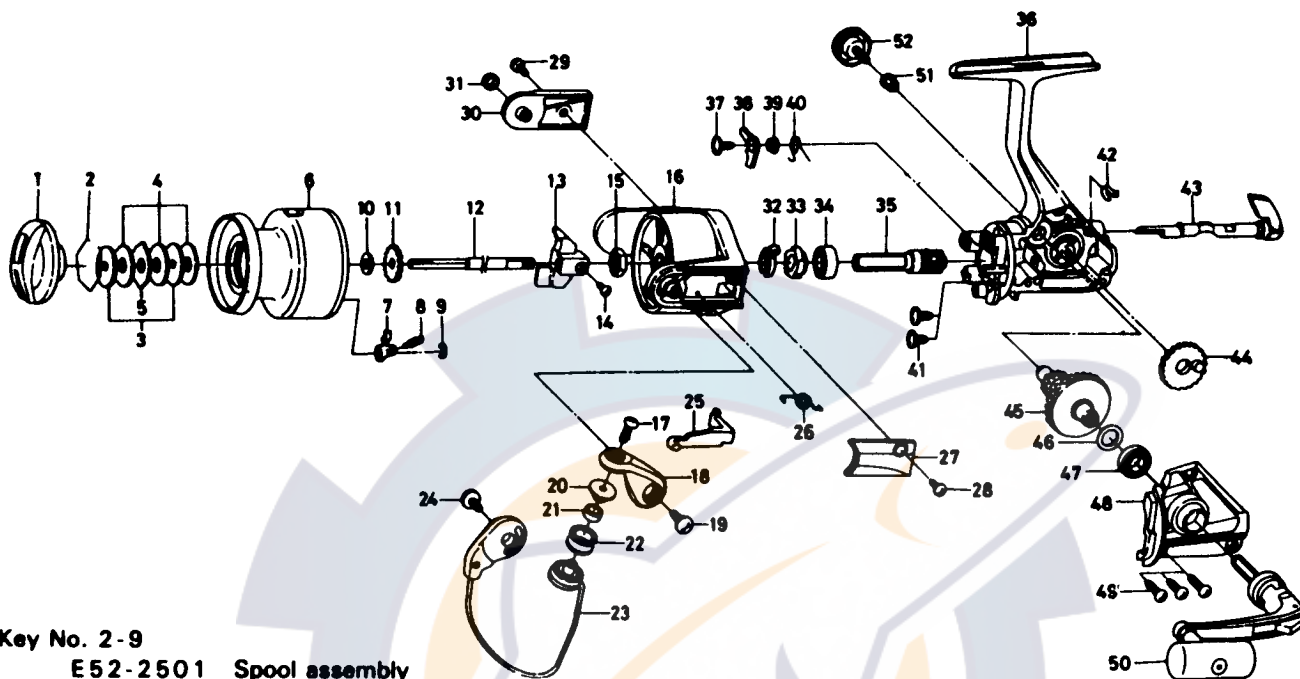

Key No. 2-9

E52-2501 Spool assembly

Key

No.	Parts No.	Parts Name
1	F19-9101	Drag knob
2	171-7701	Drag washer retainer
3	E46-7201	Key washer
4	E13-6001	Drag washer
5	373-3603	Eared washer
6	E52-2601	Spool assembly
7	B07-5304	Click pawl
8	E40-3101	Click spring
9	320-5901	Click retainer
10	L02-5001	Spool washer
11	270-6501	Click gear
12	E49-8401	Main shaft
13	F12-2301	Oscillating slider
14	351-0311	Oscillating block screw
15	341-9201	Rotor nut
16	E50-0505	Rotor
17	B67-9305	Line roller screw
18	F17-2401	Bail arm
19	E00-7102	Bail arm screw
20	F08-6301	Line roller collar
21	F05-5601	Ball bearing A
22	F05-8901	Line roller
23	F17-2501	Bail assembly
24	353-8208	Bail trip cam screw
25	E49-6401	Bail trip lever
26	E49-6801	Bail spring

Key

No.	Parts No.	Parts Name
27	E49-6201	Bail spring cover
28	E36-4201	Bail spring cover screw
29	L01-1701	Bail trip cover screw
30	F17-2901	Bail trip cover
31	F17-3001	Bail trip collar
32	F12-2101	Anti-reverse pawl spring A
33	F12-1801	Anti-reverse ratchet
34	634-1301	Ball bearing B
35	F12-1601	Pinion gear
36	F17-2201	Body assembly
37	F12-5701	Anti-reverse pawl screw
38	F12-1901	Anti-reverse pawl
39	F12-3501	Anti-reverse pawl collar
40	F12-3401	Anti-reverse pawl spring B
41	E03-7801	Bearing retainer screw
42	F12-2001	Anti-reverse cam spring
43	F08-5117	Anti-reverse lever
44	F12-2201	Oscillating gear
45	F12-1501	Drive gear
46	375-8500	Drive gear washer
47	634-1301	Ball bearing C
48	F16-2105	Side cover
49	E15-8601	Side cover screw
50	E52-2701	Handle assembly
51	501-8501	Handle collar
52	B92-5005	Handle lock screw